

1 1/2" BORE STAINLESS STEEL CYLINDER



CDR-24-□-□

Double Acting



Mount: Clevis **Standard Stroke Lengths:** 1/2", 1", 1-1/2", 2", 3", 4"
Type: Rotating Rod 6, 8", 10", 12"
Options: C, F, R, MB, B, W, V, P2, P3, P4, P5, P6, P7, P8, N For magnetic bumpers add .312

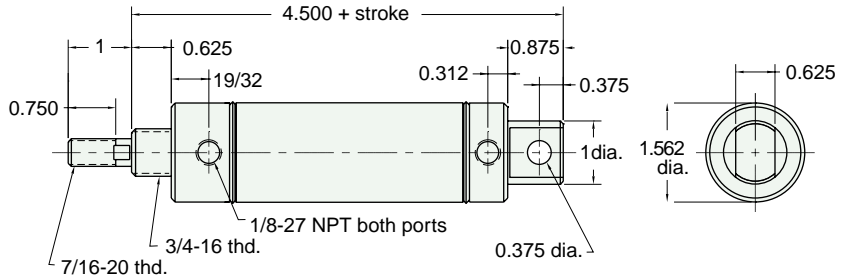

Furnished without nut(s). See Chart on Page 46.

EDR-24-□-□

Double Acting



Mount: End **Standard Stroke Lengths:** 1/2", 1", 1-1/2", 2", 3", 4", 6, 8", 10", 12"
Type: Rotating Rod
Options: C, F, R, MB, B, W, V, P6, P7, P8, N For magnetic bumpers add .312

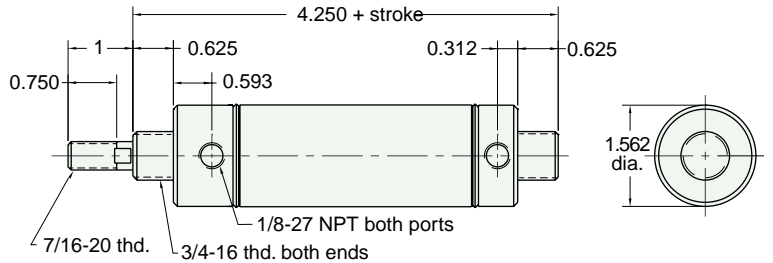

Nuts included, but not shown on drawing

FDR-24-□-□

Double Acting



Mount: Front **Standard Stroke Lengths:** 1/2", 1", 1-1/2", 2", 3", 4", 5", 6"
Type: Rotating Rod
Options: MB, B, W, V, P6, P7, P8, S, N For magnetic bumpers add .312

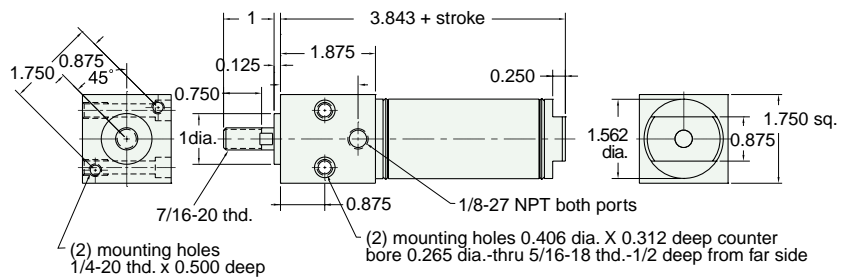

For S option add .187

SDR-24-□-□

Double Acting



Mount: Stud **Standard Stroke Lengths:** 1/2", 1", 1-1/2", 2", 3", 4", 6, 8", 10", 12"
Type: Rotating Rod
Options: C, F, R, MB, B, W, V, P6, P7, P8, S, N For magnetic bumpers add .312

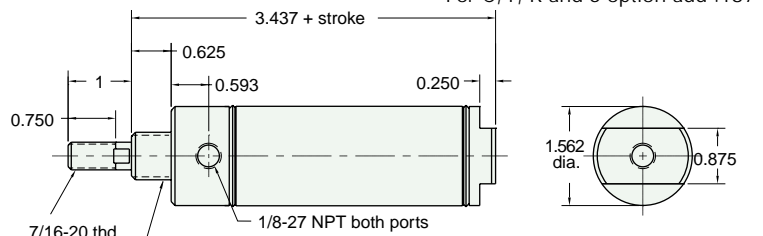

Nut included, but not shown on drawing
 For C, F, & R options use side ported rear head